

Specification Sheet

Noise Deck 32 Floor System

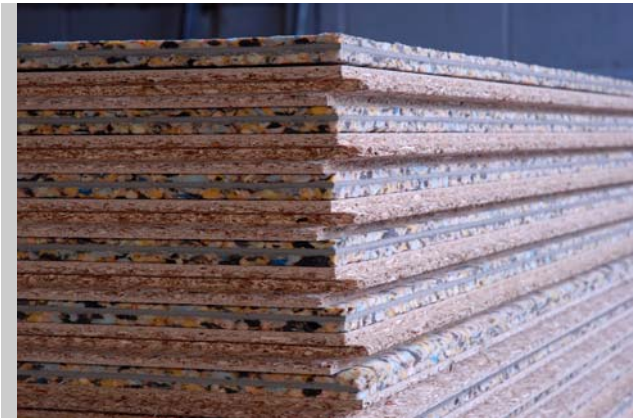

- **32mm Thickness**
- **Excellent Part E component**
- **Floating Floor**
- **2400mm x 600mm**

Product Description:

The Noise Deck 32 is made up of 18mm moisture resistant chipboard with a foam and rubber composite to the base. It is designed to be used as a floating floor which must not be nailed or screwed to any floor or joists.

It is important to ensure that the Noise Deck 32 is installed correctly. Full installation advice and information can be provided by our technical team.

The Noise Deck 32 can be used to count towards the Building Regulations Part E when used as part of our soundproofing system detailed below.

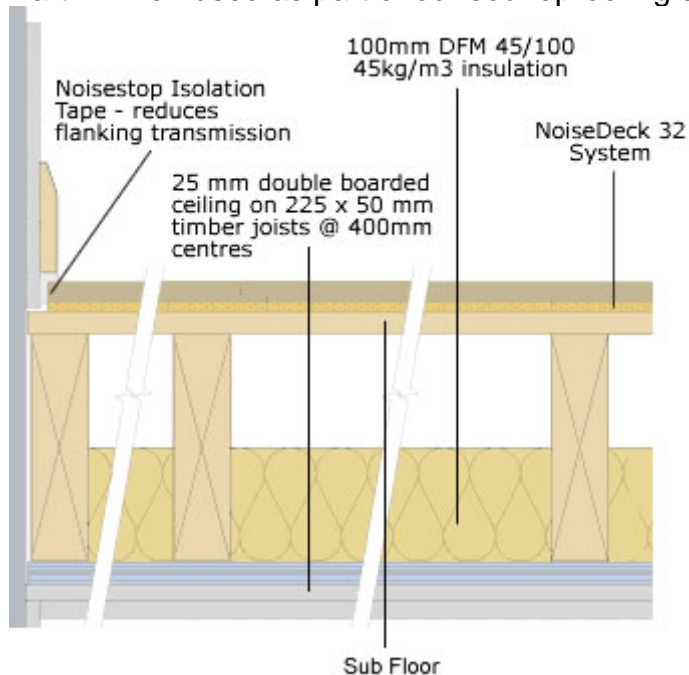

Specification Sheet

The acoustic insulation shall be:

Specification

NoiseStop Systems NoiseDeck 32 on 225 x 50mm timber joists at 400mm centres, using Isolation Tape around the perimeter and pack joists with 100mm of 45kg/m³ insulation with a 25mm double boarded ceiling on to Sound Breaker Bars.

NoiseStop Systems NoiseDeck 36 sound transmission performance

[performance figures are currently estimated as trials continue]

	$D_{nT,w} + C_{tr}$	$L'_{nT,w}$
Treated floor	48dB	53dB

Installation

- Fix Noise Stop Isolation Tape, for acoustic flanking resistance, at the floor perimeter.
- Lay the Noise Deck 32 over floor, in staggered broken bond pattern, generously applying adhesive to all tongued and grooved panel joints.
- Install skirting.

Materials Required

Noise Deck 32
 Noise Stop Isolation Tape
 DFM100 (45kg/m³)
 Sound Breaker Bars

Product Data:

Size	1200mm x 1200mm
Depth	32mm
Weight	30kg
Covers An Area Of	1.44m²