

Specification Sheet

Noise Deck 36 Floor System



- 36mm Thickness
- Excellent Part E component
- Floating Floor
- 2400mm x 600mm
- Maximum noise reduction on impact, airborne and flanking

Product Description:

The Noise Deck 36 is made up of 22mm moisture resistant chipboard with a foam and rubber composite to the base. It is designed to be used as a floating floor which must not be nailed or screwed to any floor or joists.

It is important to ensure that the Noise Deck 36 is installed correctly. Full installation advice and information can be provided by our technical team.

The Noise Deck 36 can be used to count towards the Building Regulations Part E when used as part of our soundproofing system detailed below:

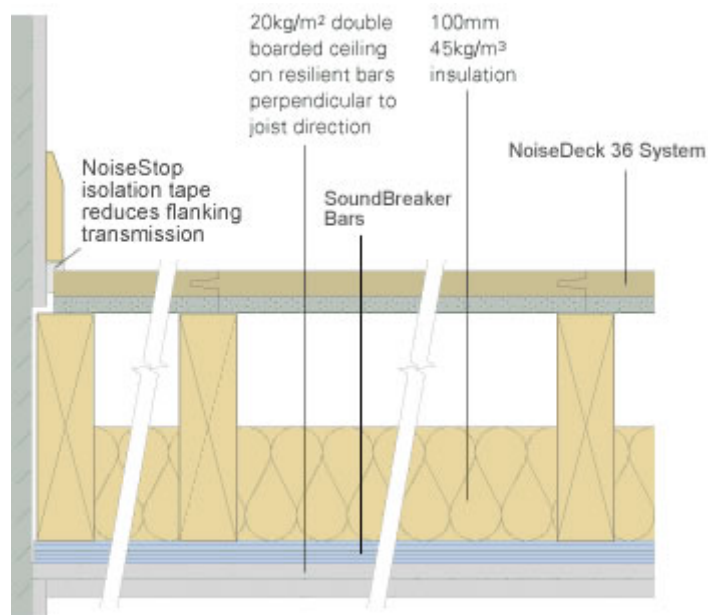

Specification Sheet

The acoustic insulation shall be:

Specification

NoiseStop Systems NoiseDeck 36 on 225 x 50mm timber joists at 400mm centres, using Isolation Tape around the perimeter and pack joists with 100mm of 45kg/m³ insulation with a 25mm double boarded ceiling onto Sound Breaker Bars.

No other flooring products would be required as the NoiseDeck 36 would be applied directly on to the joists.

NoiseStop Systems NoiseDeck 36 sound transmission performance [performance figures are currently estimated as trials continue]

	$D_{nT,w} + C_{tr}$	$L'_{nT,w}$
Treated floor	48dB	53dB

Installation

- Fix Noise Stop Isolation Tape, for acoustic flanking resistance, at the floor perimeter.
- Lay the Noise Deck 36 over floor joists, in staggered broken bond pattern, generously applying adhesive to all tongued and grooved panel joints.
- Install skirting.

Materials Required

NoiseStop NoiseDeck 36
NoiseStop Isolation Tape
DFM100 (45kg/m³)
Sound Breaker Bars

Product Data:

Size	2400mm x 600mm
Depth	36mm
Weight	35kg
Covers An Area Of	1.44m²