

Specification Sheet

Noise Deck Solo Floor System

Product Description:

The Noise Deck Solo is made up of 18mm moisture resistant chipboard with a foam composite to the base. It is designed to be used as a floating floor which must not be nailed or screwed to any floor or joists.

It is important to ensure that the Noise Deck Solo is installed correctly. Full installation advice and information can be provided by our technical team.

- **28mm Thickness**
- **Excellent Part E component**
- **Floating Floor**
- **2400mm x 600mm**

The Noise Deck Solo can be used to count towards the Building Regulations Part E when used as part of our soundproofing system detailed below.

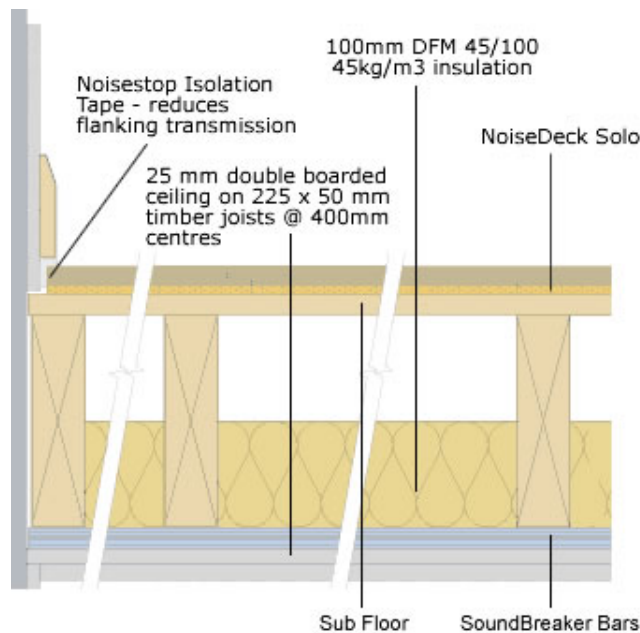

Specification Sheet

The acoustic insulation shall be:

Specification

Noise Stop Systems Noise Deck Solo onto full prepared and repaired existing flooring, using Isolation Tape around the perimeter and pack joists with 100mm of 45kg/m³ insulation with a 25mm double boarded ceiling on to Sound Breaker Bars.

Noise Stop Systems Solo sound transmission performance

[performance figures are currently estimated as trials continue]

	$D_{nT,w} + C_{tr}$	$L'_{nT,w}$
Treated floor	48dB	55dB

Installation

- Fully prepare the existing floor, filling in all gaps and holes. Secure the existing floor to the joists. Apply the Noise Deck Solo as a floating floor.
- Fix Noise Stop Isolation Tape, for acoustic flanking resistance, at the floor perimeter.
- Lay the Noise Deck Solo over existing floor, in an interlocking staggered pattern, generously applying adhesive to all tongued and grooved panel joints.
- Install skirting.

Materials Required

Noise Deck Solo
 NoiseStop Isolation Tape
 DFM100 (45kg/m³)
 Sound Breaker Bars

Product Data:

Size	2400mm x 600mm
Depth	28mm
Weight	16kg
Covers An Area Of	1.44m²