

Fitting the AcoustiClips and AcoustiChannel

How to fit and space the AcoustiClip and AcoustiChannel to walls and ceilings

Attaching the AcoustiClip and the AcoustiChannel

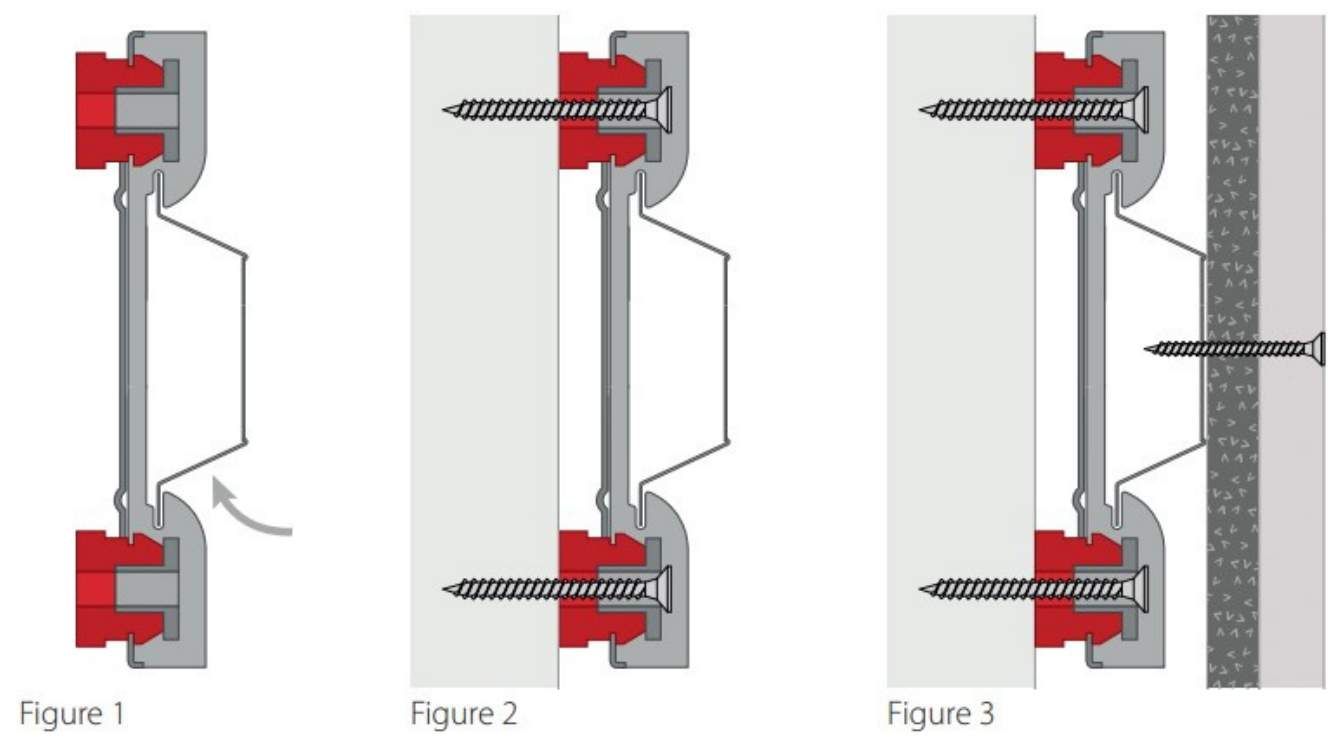

Spacing the AcoustiClip and the AcoustiChannel

Ceilings

When fitting AcoustiClips and AcoustiChannels, maintain a maximum distance of 600mm between the channels. Similarly, along the length of the AcoustiChannel, ensure that the maximum distance between AcoustiClips does not exceed 900mm.

For ceilings with timber joists, we suggest installing an AcoustiClip approximately every other joist along the joist length, ensuring a maximum distance of 600mm between the clips and 900mm along the channels.

The maximum distance from the wall to the AcoustiClip should be no more than 150mm.

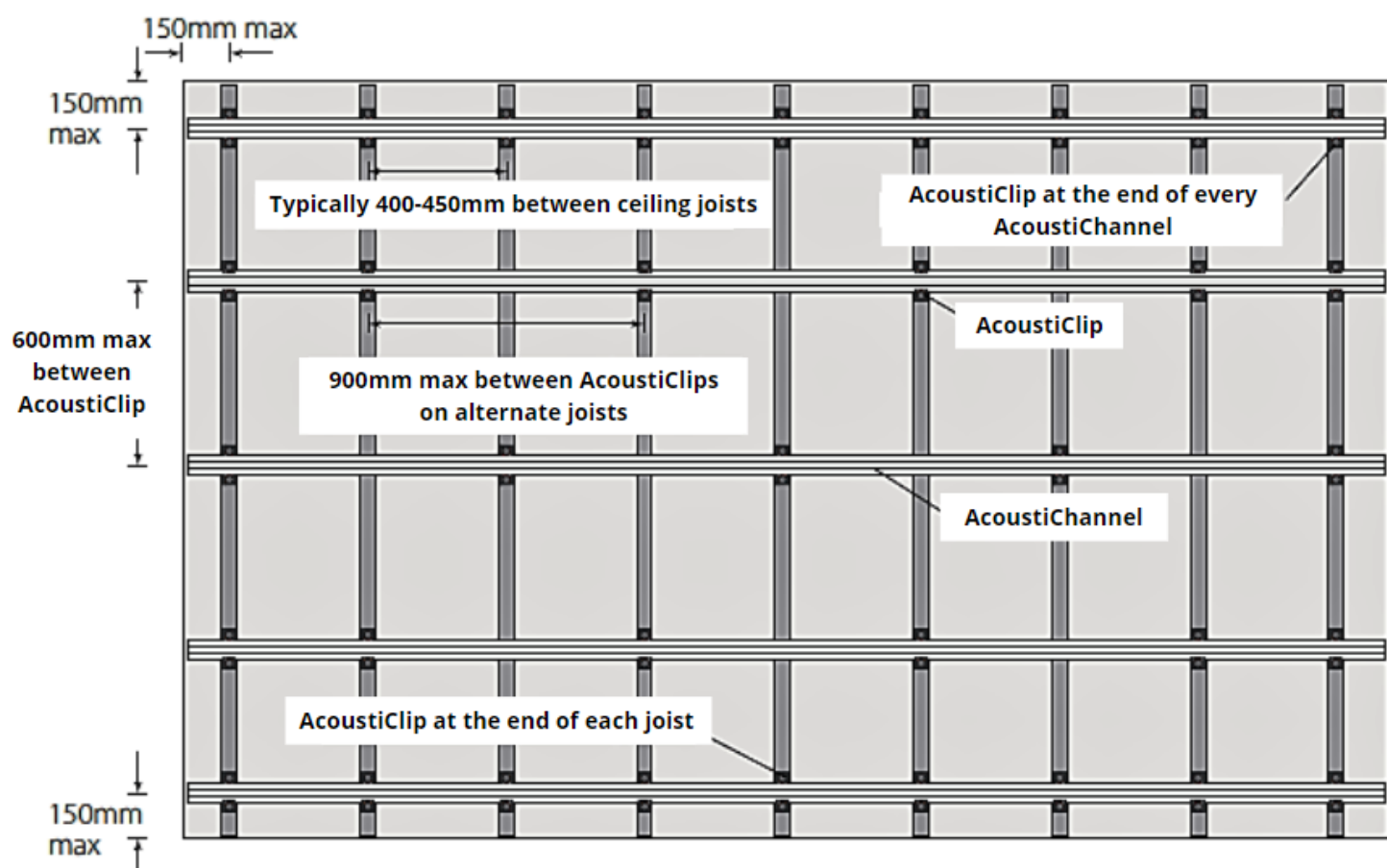

Timber Joist Ceiling

Concrete Ceiling

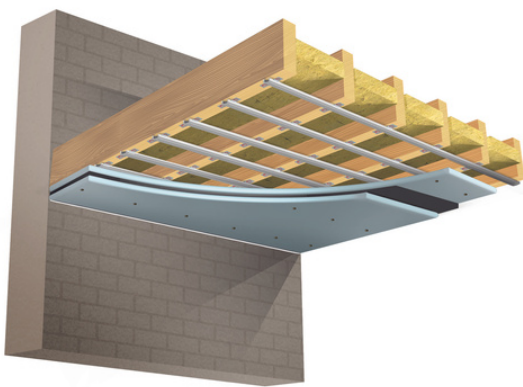

AcoustiClip - Sound isolation clip system for walls and ceilings

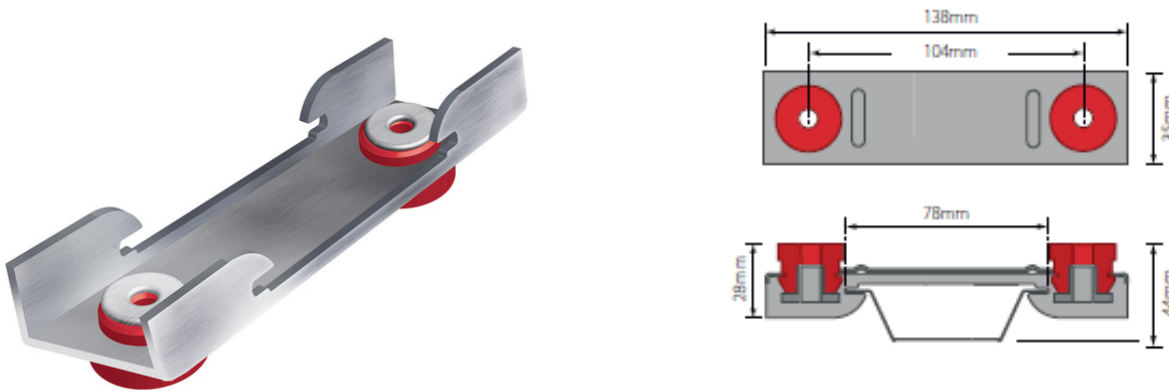

Figure 1: Attach the channel to the clip by either pinching the metal channel into the clip or sliding the clips onto the channel before fitting the clips.

Figure 2: The AcoustiClip is fixed in place using a standard screw 55mm minimum length. If you are fitting to a surface that requires drilling, use standard brown wall plugs and screws.

Figure 3: Attach the boards to the AcoustiChannel with drywall screws. The screw should go into the AcoustiChannel by a minimum of 10mm.

Join lengths of AcoustiChannel by Overlapping them by 100mm and screwing them together with a drywall screw.

Walls

When fitting AcoustiClips and AcoustiChannels, maintain a maximum distance of 600mm between the channels, vertically up the wall. Similarly, along the length of the AcoustiChannel, ensure that the maximum distance between AcoustiClips does not exceed 1200mm.

The maximum distance from the floor to the first row should be no more than 75mm.

The maximum distance from the ceiling and the final row should be no more than 150mm.

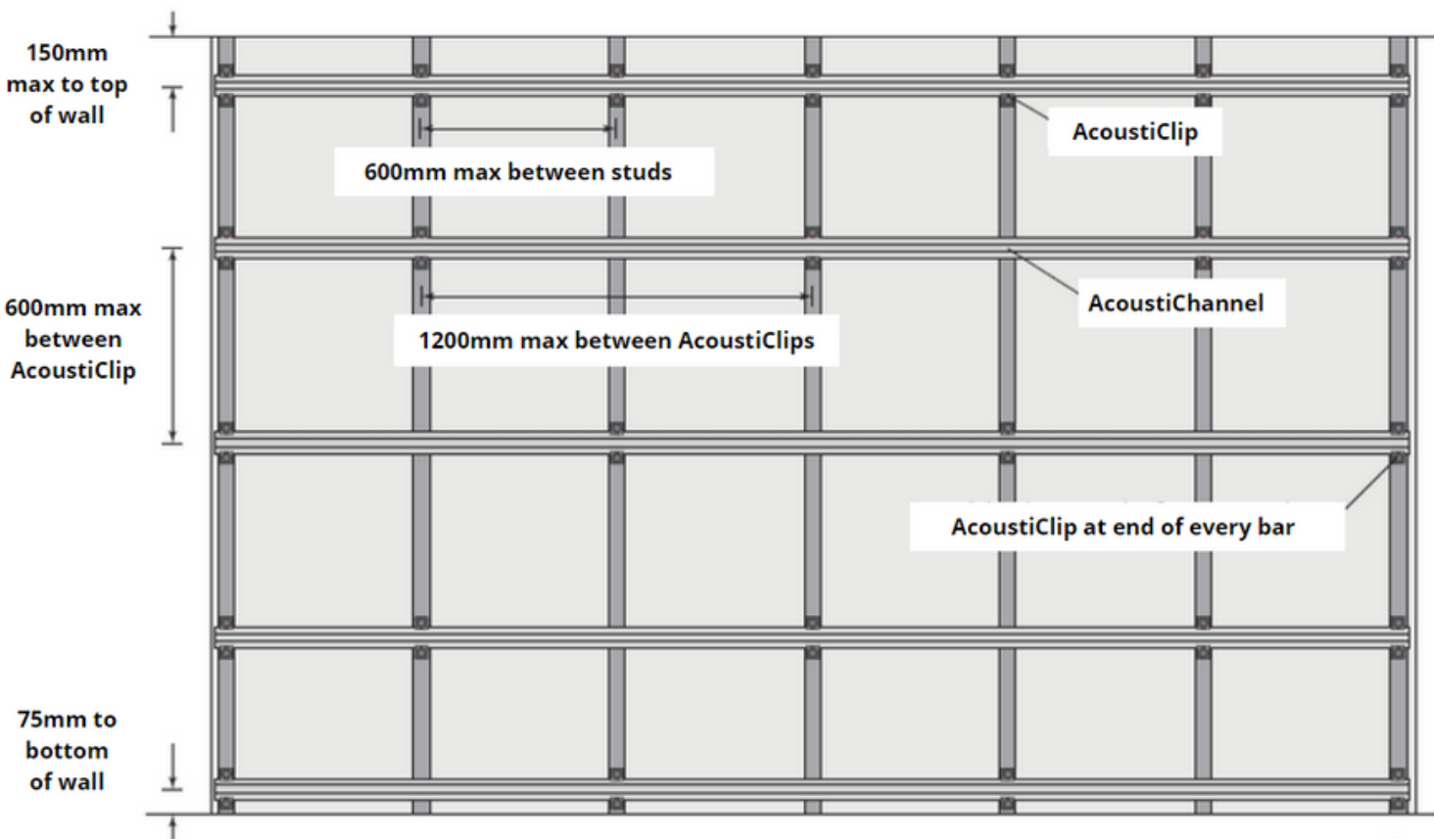

Direct to Wall

Stud Wall

